

# Instructions: Butterfly Table Lamp



- 1. Gather all components:**  
(5 x Butterfly Pieces, 2 x Washers, 2 x Joining pieces (big opening & small opening), 1x Lamp Base & holding rod.)



- 2. Take 2 Butterfly pieces (1 with a split at the top and 1 with a split at the bottom). Slip together and clip each groove into place.**



- 3. Repeat Process until all 5 butterfly pieces are joined together to make a ring of butterflies.**

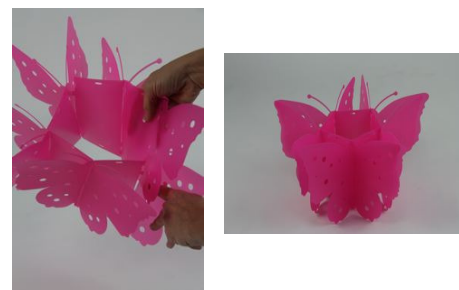

- 4. Select joining piece with the big opening. Attach this to the bottom of the butterfly and clip into place.**



# Instructions: Butterfly Table Lamp



5. **Select joining piece with the small opening. Attach this to the top Of the butterfly and clip into place.**

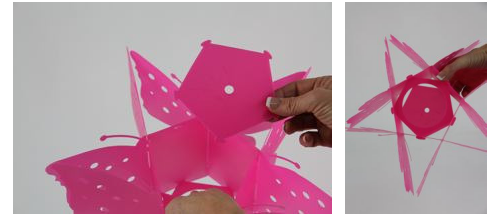

6. **Set aside**



7. **Insert a globe into the lamp base and add the washer to sit on top.**



8. **Place the butterfly head over the globe and position in place adding the second washer on the top.**



9. **Screw the holding rod into place**



10. **Enjoy**

